

Extra-Wide Flange Center Pull-Tab

This tapered plug features a center pull-tab design that extends above the flange for easy removal. The extra-wide flange protects more surface area, preventing improper installation.

NOTE: "B" dimension should be at least .02" more than diameter to be plugged. Larger diameters may require more interference.

Material: Low-Density Polyethylene **Color:** Orange

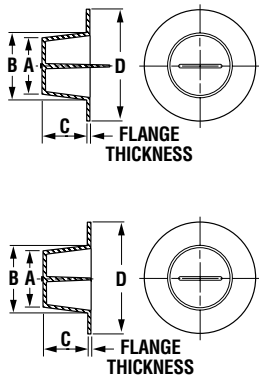

[†]660 Series

Caplug No.	Dimensions											Packaging		
	To Plug Thread Sizes				A		B		C		D		Carton Quantity	Mini Pak Quantity
	NPT/BSP	Standard	Metric	Hole	In	mm	In	mm	In	mm	In	mm		
662 [†]	-	9/16	-	1/2	.480	12.19	.540	13.72	.53	13.46	1.25	31.75	5000	1000
242-WP	-	11/16	M18x1.5	5/8	.590	14.99	.647	16.43	.50	12.70	1.06	26.92	5000	1000
663 [†]	1/2	-	-	3/4	.730	18.54	.790	20.07	.50	12.70	1.50	38.10	3000	600
246-WP	-	7/8	M24	-	.752	19.10	.849	21.56	.50	12.70	1.31	33.27	2500	500
664 [†]	3/4	-	-	1	.980	24.89	1.040	26.42	.53	13.46	1.88	47.75	1500	300
248-WP	-	1-1/16	M27x2	-	.921	23.39	1.075	27.31	.75	19.05	1.62	41.15	1500	300
153-2-WP	-	-	-	-	1.069	27.15	1.188	30.18	.69	17.53	1.73	43.94	1000	200
250-WP	-	1-15/16	M33x2/M36	-	1.202	30.53	1.297	32.94	.75	19.05	1.88	47.75	1000	200
665 [†]	-	-	-	1-1/4	1.230	31.24	1.290	32.77	.50	12.70	2.00	50.80	1200	240
666 [†]	-	-	-	1-1/2	1.460	37.08	1.550	39.37	.75	19.05	2.38	60.45	500	100
194-WP	1-1/4	1-5/8	-	-	1.519	38.58	1.602	40.69	.75	19.05	2.25	57.15	500	100
196-3-WP	-	-	-	-	1.807	45.90	1.932	49.07	.75	19.05	2.53	64.26	500	100
667 [†]	2	-	-	2	1.960	49.78	2.050	52.07	.75	19.05	2.75	69.85	500	100
668 [†]	-	-	-	2-1/2	2.460	62.48	2.550	64.77	.75	19.05	3.25	82.55	250	50

[†]660 Series have a tab flush with flange (see drawing)

* For other material and color options, contact a Daemar Sales Representative.