

FTC Series

Caps for Flareless Tube and Nut Assemblies



Featuring a “cap within a cap” design, Series FTC closures can be easily applied to flareless hydraulic tube and nut assemblies. As the FTC Cap is pushed on the nut, the “outer cap” conforms to the hex shape of the nut, while the “inner cap” covers the tube and sleeve inside the nut to hold the assembly firmly in place. This series was formerly known as the FC Series.



Material: Low-Density Polyethylene **Color*:** Red

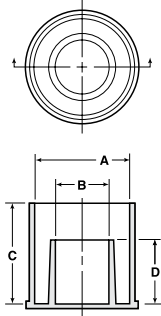

Caplug No.	Dimensions								Packaging		
	To Fit Tube Size	A		B		C		D		Carton Quantity	Mini Pak Quantity
		In	mm	In	mm	In	mm	In	mm		
FTC-2	1/8	.39	9.91	.17	4.32	.58	14.73	.40	10.16	5000	1000
FTC-3	3/16	.46	11.68	.24	6.10	.63	16.00	.41	10.41	5000	1000
FTC-4	1/4	.59	14.99	.30	7.62	.77	19.56	.52	13.21	5000	1000
FTC-5	5/16	.65	16.51	.37	9.40	.81	20.57	.53	13.46	5000	1000
FTC-6	3/8	.72	18.29	.41	10.41	.81	20.57	.54	13.72	5000	1000
FTC-8	1/2	.91	23.11	.57	14.48	.86	21.84	.54	13.72	2500	500
FTC-10	5/8	1.04	26.42	.67	17.02	.99	25.15	.64	16.26	2500	500
FTC-12	3/4	1.30	33.02	.83	21.08	1.00	25.40	.64	16.26	1000	200
FTC-16	1	1.56	39.63	1.07	27.18	1.10	27.94	.63	16.00	1000	200
FTC-20	1-1/4	2.08	52.83	1.32	33.53	1.10	27.94	.62	15.75	1000	200
FTC-24	1-1/2	2.36	59.95	1.56	39.63	1.08	27.43	.62	15.75	500	100
FTC-28	1-3/4	2.76	70.11	1.83	46.48	1.14	28.96	.69	17.53	500	100
FTC-32	2	3.00	76.20	2.06	52.33	1.17	29.72	.63	16.00	250	50

* For other material and color options, contact a Daemar Sales Representative.