

K Series Plugs For Round Tubing

Expanded!



Series K Tubing Plugs are specially designed for applications where the outside diameter of the closure should not exceed the outside diameter of the tubing. Flanges fit flush with outer walls of tubing, providing positive protection against moisture and dirt. Especially suitable for general purpose, Type K copper tubing, SAE Standard J-528.



Material: Low-Density Polyethylene **Color*:** Red **Applicable Specs:** MIL-C-5501/8, NAS 843

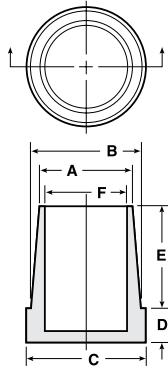

| Caplug No. | Will Plug SAE J-528 Tubing or O.D. Inches | Dimensions | | | | | | | | | | | | Packaging | |
|----------------------|---|------------|-------|------|-------|-----|-------|-----|------|-----|-------|-----|-------|-----------------|-------------------|
| | | A | | B | | C | | D | | E | | F | | Carton Quantity | Mini Pak Quantity |
| | | In | mm | In | mm | In | mm | In | mm | In | mm | In | mm | | |
| K-2.5mm [†] | - | .160 | 4.06 | .165 | 4.19 | .22 | 5.59 | .12 | 3.05 | .26 | 6.60 | .10 | 2.64 | 5000 | 1000 |
| K-3 | 3/16 | .105 | 2.67 | .138 | 3.51 | .19 | 4.83 | .19 | 4.83 | .31 | 7.87 | .08 | 1.78 | 5000 | 1000 |
| K-3S | 3/16 | .105 | 0.27 | .138 | 3.51 | .19 | 4.83 | .06 | 1.52 | .31 | 7.87 | .08 | 1.78 | 5000 | 1000 |
| RP-2 | 3/16 | .105 | 2.67 | .140 | 3.56 | .19 | 4.83 | .13 | 3.30 | .25 | 6.35 | - | - | 15000 | 3000 |
| K-4 | 1/4 | .160 | 4.06 | .202 | 5.13 | .24 | 6.10 | .14 | 3.56 | .38 | 9.65 | .14 | 3.30 | 5000 | 1000 |
| RP-3 | 1/4 | .165 | 4.19 | .210 | 5.33 | .25 | 6.35 | .13 | 3.30 | .25 | 6.35 | - | - | 35000 | 7000 |
| K-5 | 5/16 | .227 | 5.77 | .272 | 6.91 | .31 | 7.87 | .14 | 3.56 | .38 | 9.65 | .20 | 5.08 | 5000 | 1000 |
| K-6 | 3/8 | .290 | 7.37 | .340 | 8.64 | .37 | 9.40 | .16 | 4.06 | .38 | 9.65 | .26 | 6.60 | 5000 | 1000 |
| RP-4S | 3/8 | .290 | 7.37 | .330 | 8.38 | .38 | 9.65 | .13 | 3.30 | .54 | 13.72 | - | - | 10000 | 2000 |
| RP-5 | 3/8 | .290 | 7.37 | .345 | 8.76 | .38 | 9.65 | .13 | 3.30 | .50 | 12.70 | - | - | 10000 | 2000 |
| K-8 | 1/2 | .411 | 10.44 | .466 | 11.84 | .50 | 12.70 | .16 | 4.06 | .38 | 9.65 | .38 | 9.65 | 5000 | 1000 |
| K-10 | 5/8 | .530 | 13.46 | .587 | 14.91 | .62 | 15.75 | .19 | 4.83 | .56 | 14.22 | .50 | 12.70 | 5000 | 1000 |
| RP-7S | 11/16 | .550 | 13.97 | .640 | 16.26 | .69 | 17.53 | .13 | 3.30 | .50 | 12.70 | - | - | 7500 | 1500 |
| K-11S | 5/8 | .530 | 13.46 | .580 | 14.73 | .67 | 17.02 | .37 | 9.40 | .56 | 14.22 | .51 | 12.95 | 5000 | 1000 |
| K-12 | 3/4 | .650 | 16.51 | .712 | 18.09 | .75 | 19.05 | .19 | 4.83 | .56 | 14.22 | .62 | 15.75 | 5000 | 1000 |
| K-12S | - | .609 | 15.47 | .664 | 16.87 | .73 | 18.54 | .38 | 9.65 | .56 | 14.22 | .58 | 14.73 | 5000 | 1000 |
| RP-9 | 29/32 | .734 | 18.64 | .834 | 21.18 | .91 | 23.11 | .13 | 3.30 | .62 | 15.75 | - | - | 3500 | 700 |

[†]K-2.5mm is for fiber optic connectors, and also available in Black.

* For other material and color options, contact a Daemar Sales Representative.