

SC Series Sleeve Caps for Tube Ends

Expanded!



Series SC Sleeve Caps are designed to fit outside diameters of tubing sizes listed with a snug friction grip. Available in over 128 different outside diameters and lengths, the SC Series is ideal for capping and protecting both threaded and non-threaded tubing or rod ends. They also make excellent masks for painting, plating or grit-blasting operations.



Material: Low-Density Polyethylene **Color*:** Red **Applicable Specs:** MIL-C-52078, MIL-C-5501/9, NAS 844

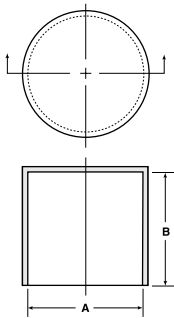

Caplug No.	Dimensions				Packaging	
	A – Press Fit on O.D.		B		Carton Quantity	Mini Pak Quantity
	In	mm	In	mm		
SC-5/64**	.078	1.98	.50	12.70	5000	1000
SC-3/32	.094	2.38	.59	14.99	5000	1000
SC-1/8	.125	3.18	.59	14.99	5000	1000
211-L	.125	3.18	.75	19.05	25000	5000
SC-5/32	.156	3.97	.56	14.22	5000	1000
212-S	.172	4.37	.62	15.75	10000	2000
SC-3/16-5	.188	4.76	.35	8.89	5000	1000
213-S	.188	4.78	.47	11.94	25000	5000
SC-3/16-10	.188	4.76	.59	14.99	5000	1000
SC-3/16-16	.188	4.76	1.00	25.40	5000	1000
213-R	.203	5.16	.62	15.75	15000	3000
SC-7/32	.219	5.56	.75	19.05	5000	1000
SC-1/4-4	.250	6.35	.22	5.59	5000	1000
SC-1/4-7	.250	6.35	.44	11.18	5000	1000
214-S	.250	6.35	.50	12.70	15000	3000
SC-1/4-14	.250	6.35	.88	22.35	5000	1000
SC-1/4-16	.250	6.35	1.00	25.40	5000	1000
274-G	.266	6.76	.75	19.05	10000	2000
SC-9/32	.281	7.14	.75	19.05	5000	1000
1805	.313	7.92	.38	9.65	18000	3600
SC-5/16	.313	7.94	.88	22.35	5000	1000
216-T	.375	9.53	.46	11.68	20000	4000
155†	.375	9.53	.75	19.05	10000	2000
SC-3/8	.375	9.53	.88	22.35	5000	1000
216-L	.375	9.53	1.12	28.45	7500	1500
1030	.422	10.72	1.25	31.75	5000	1000
773	.438	11.11	.22	5.59	15000	3000
SC-7/16-8	.438	11.11	.50	12.70	5000	1000
159	.438	11.11	.62	15.75	10000	2000
SC-7/16-14	.438	11.11	.88	22.35	5000	1000
217-L	.438	11.11	1.50	38.10	5000	1000
SC-7/16-16	.438	11.11	1.00	25.40	5000	1000
157†	.469	11.90	.75	19.05	7500	1500
161†	.500	12.70	.44	11.18	15000	3000
SC-1/2-8	.500	12.70	.50	12.70	5000	1000
SC-1/2-14	.500	12.70	.88	22.35	5000	1000
SC-1/2-24	.500	12.70	1.50	38.10	2500	500
176†	.563	14.27	.42	10.67	10000	2000
SC-9/16-9	.563	14.29	.56	14.22	5000	1000
219-S	.563	14.27	.62	15.75	7500	1500
SC-9/16-14	.563	14.29	.88	22.35	5000	1000
1868	.625	15.87	.64	16.26	6500	1300
SC-5/8	.625	15.88	.88	22.35	5000	1000
981††	.625	15.88	.88	22.35	5000	1000
220-H	.625	15.88	.94	23.88	5000	1000
220-U	.625	15.88	1.50	38.10	2000	400
1834	.625	15.88	2.50	63.50	1000	200
221-S	.688	17.48	.75	19.05	5000	1000
SC-11/16	.688	17.46	.88	22.35	5000	1000
222-S	.750	19.05	.38	9.65	7500	1500
SC-3/4	.750	19.05	.88	22.35	5000	1000
SC-3/4-16	.742	18.85	1.00	25.40	5000	1000
222-H	.750	19.05	.94	23.88	2500	500
222-L	.750	19.05	2.47	62.74	4000	800
SC-25/32	.781	19.84	1.00	25.40	5000	1000
835	.813	20.65	.69	17.53	3500	700
SC-13/16	.813	20.64	.88	22.35	5000	1000
201-T	.875	22.23	.62	15.75	2500	500
201-S	.875	22.23	.62	15.75	3500	700
SC-7/8	.875	22.23	.88	22.35	5000	1000
201-M	.875	22.23	1.75	44.45	1000	200
748	.906	23.00	.75	19.05	2500	500
1202	.906	23.83	.88	22.35	2500	500
SC-15/16	.938	23.81	1.00	25.40	2500	500
1784	1.000	25.40	.50	12.70	3500	700

** Material for this part is Polyolefin Elastomer.

† Parts have external ribs.

†† Parts have internal ribs.

* For other material and color options, contact a Daemar Sales Representative.

SC Series Sleeve Caps for Tube Ends (cont.)



Caplug No.	Dimensions				Packaging	
	A – Press Fit on O.D.		B		Carton Quantity	Mini Pak Quantity
	In	mm	In	mm		
2003	1.000	25.40	.50	12.70	3500	700
1364	1.000	25.40	.62	15.75	2000	400
138	1.000	25.40	.75	19.05	2500	500
SC-1	1.000	25.40	1.00	25.40	2500	500
138-L	1.000	25.40	1.75	44.45	1000	200
SC-1-1/16	1.063	26.99	1.00	25.40	2500	500
224	1.125	28.58	.88	22.35	1500	300
SC-1-1/8	1.125	28.58	1.00	25.40	2500	500
SC-1-1/8-21	1.125	28.58	1.31	33.27	2000	400
SC-1-3/16	1.188	30.16	1.00	25.40	2500	500
289-S	1.250	31.75	.50	12.70	2000	400
1831	1.250	31.75	.87	22.10	1000	200
SC-1-1/4	1.250	31.75	1.00	25.40	2000	400
289-M	1.250	31.75	1.50	38.10	700	140
289-L	1.250	31.75	1.75	44.45	500	100
SC-1-5/16-12	1.313	33.34	.75	19.05	3000	600
SC-1-5/16	1.313	33.34	1.00	25.40	1000	200
760	1.375	35.00	.62	15.75	1000	200
SC-1-3/8	1.375	34.92	1.00	25.40	1000	200
428	1.375	35.00	1.50	38.10	500	100
428-2	1.375	35.00	1.59	40.39	500	100
SC-1 1/2	1.500	38.10	1.00	25.40	1000	200
290-L	1.500	38.10	1.75	44.45	500	100
1975	1.500	38.10	.87	22.10	1000	200
SC-1-5/8	1.625	41.28	1.00	25.40	1000	200
291-L	1.625	41.28	1.25	31.75	500	100
291-2	1.719	43.65	1.00	25.40	500	100
1008	1.750	44.45	.88	22.35	500	100
SC-1-3/4	1.750	44.45	1.00	25.40	1000	200
291-3	1.844	46.84	1.21	30.73	500	100
SC-1-7/8	1.875	47.63	1.00	25.40	1000	200
SC-1-29/32	1.906	48.41	1.00	25.40	1000	200
SC-2	2.000	50.80	.88	22.35	1000	200
226	2.000	50.80	1.00	25.40	1000	200
226-L	2.000	50.80	1.53	38.86	250	50
1025	2.125	53.98	.50	12.70	1000	200
SC-2-1/8	2.125	53.98	1.00	25.40	500	100
SC-2-1/4	2.250	57.15	.88	22.35	500	100
1365	2.250	57.15	1.00	25.40	300	60
SC-2-3/8	2.375	60.33	.88	22.35	500	100
SC-2-1/2	2.500	63.50	.88	22.35	500	100
SC-2-9/16	2.563	65.10	1.00	25.40	500	100
372	2.609	66.27	1.00	25.40	1000	200
SC-2-5/8	2.625	66.68	1.00	25.40	500	100
SC-2-3/4	2.750	69.85	1.00	25.40	500	100
SC-3	3.000	76.20	1.00	25.40	450	90
SC-3-1/8	3.125	79.38	1.38	35.05	250	50
1528	3.250	82.55	1.00	25.40	800	160
SC-3-5/16	3.313	84.14	1.00	25.40	400	100
1563	3.438	87.31	1.00	25.40	700	140
1521	3.500	88.90	1.00	25.40	600	120
SC-3-1/2	3.500	88.90	1.38	35.05	250	50
2215	3.531	89.69	2.00	50.80	300	60
SC-3-5/8	3.625	92.08	1.38	35.05	250	50
SC-3-3/4	3.750	95.25	1.38	35.05	200	40
SC-4	4.000	101.60	1.38	35.05	250	50
1540	4.000	101.60	1.13	28.70	500	100
SC-4-1/8	4.125	104.78	1.50	38.10	120	24
1400	4.813	122.25	.64	16.26	500	100
1363	4.875	123.83	.92	23.37	350	70
SC-5-1/8	5.125	130.18	1.63	41.40	100	20
SC-5-1/4	5.250	133.36	1.80	45.72	50	n/a
324-3	8.000	203.20	2.30	58.42	40	8

* For other material and color options, contact a Daemar Sales Representative.