

WW Series Tapered Caps & Plugs with Wide, Thick Flanges

Expanded!



Accepted by the aircraft industry, Series WW Caps are designed with a wide, thick flange to ensure against being erroneously forced "all the way through" when used as a plug. Available in 76 sizes, this versatile part may easily be used as a cap or plug, depending upon application.



Material: Low-Density Polyethylene Color*: Yellow Applicable Spec: NAS 816

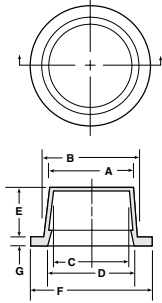

When **CAPPING**
"C" Dim. must be at least 1% smaller than diameter to be capped. Minimum .020"



When **PLUGGING**
"B" Dim. must be at least 1% larger than hole to be plugged. Minimum .020"

Caplug No.	Dimensions												Packaging			
	A		B		C		D		E		F		G		Carton Quantity	Mini Pak Quantity
	In	mm	In	mm	In	mm	In	mm	In	mm	In	mm	In	mm		
WW-00	.116	2.95	.182	4.62	.053	1.35	.120	3.05	.37	9.40	.50	12.70	.090	2.29	5000	1000
WW-0	.173	4.39	.240	6.10	.111	2.82	.177	4.50	.37	9.40	.56	14.22	.090	2.29	5000	1000
WW-0X	.230	5.84	.275	6.99	.149	3.78	.190	4.83	.31	7.87	.56	14.22	.060	1.52	10000	2000
WW-1	.236	5.99	.296	7.52	.174	4.42	.225	5.72	.31	7.87	.62	15.75	.090	2.29	5000	1000
WW-2	.299	7.59	.365	9.27	.235	5.97	.302	7.67	.31	7.87	.68	17.27	.090	2.29	5000	1000
WW-2X	.333	8.46	.392	9.96	.269	6.83	.319	8.10	.31	7.87	.72	18.29	.090	2.29	5000	1000
WW-3	.367	9.32	.418	10.62	.298	7.57	.354	8.99	.31	7.87	.75	19.05	.090	2.29	5000	1000
WW-3X	.397	10.08	.447	11.35	.328	8.33	.383	9.73	.31	7.87	.78	19.81	.090	2.29	5000	1000
WW-4	.427	10.85	.475	12.07	.356	9.04	.409	10.39	.31	7.87	.81	20.57	.090	2.29	5000	1000
WF 9	.435	11.05	.509	12.93	.365	9.27	.450	11.43	.47	11.94	.83	21.08	-	-	10000	2000
WF 9-2	.460	11.68	.500	12.70	.396	10.06	.444	11.28	.38	9.65	.75	19.05	-	-	6000	1200
WW-5	.481	12.22	.547	13.89	.409	10.39	.493	12.52	.37	9.40	.87	22.10	.090	2.29	5000	1000
WW-5X	.500	12.70	.563	14.30	.440	11.18	.500	12.70	.37	9.40	.89	22.61	.090	2.29	5000	1000
WW-6	.530	13.46	.615	15.62	.468	11.89	.547	13.89	.37	9.40	.94	23.88	.090	2.29	5000	1000
WF11-2	.560	14.22	.631	16.03	.497	12.62	.579	14.71	.47	11.94	.97	24.64	-	-	6500	1300
WW-7	.590	14.99	.667	16.94	.518	13.16	.605	15.37	.44	11.18	1.00	25.40	.090	2.29	5000	1000
WW-7X	.610	15.49	.687	17.45	.548	13.92	.635	16.13	.44	11.18	1.03	26.16	.090	2.29	5000	1000
WW-8	.628	15.95	.725	18.42	.558	14.17	.662	16.81	.44	11.18	1.06	26.92	.090	2.29	5000	1000
WW-8X	.658	16.71	.750	19.05	.588	14.94	.687	17.45	.44	11.18	1.09	27.69	.090	2.29	5000	1000
WW-9	.690	17.53	.775	19.69	.620	15.75	.721	18.31	.47	11.94	1.12	28.45	.090	2.29	5000	1000
WW-9X	.725	18.42	.812	20.62	.663	16.84	.761	19.33	.50	12.70	1.16	29.46	.090	2.29	5000	1000
WW-10	.755	19.18	.870	22.10	.693	17.60	.808	20.52	.50	12.70	1.18	29.97	.090	2.29	5000	1000
WW-11	.820	20.83	.930	23.62	.755	19.18	.865	21.97	.53	13.46	1.25	31.75	.090	2.29	2500	500
WW-11X	.825	20.96	.929	23.60	.763	19.38	.878	22.30	.56	14.22	1.25	31.75	.090	2.29	2500	500
WF 21	.866	22.00	.976	24.79	.804	20.42	.925	23.50	.65	16.51	1.81	45.97	-	-	2500	500
WW-12	.867	22.02	.975	24.77	.805	20.45	.913	23.19	.56	14.22	1.28	32.51	.090	2.29	2500	500
WW-12X	.915	23.24	1.035	26.29	.840	21.34	.960	24.38	.63	16.00	1.34	34.04	.090	2.29	2500	500
WW-13	.984	24.99	1.105	28.07	.919	23.34	1.040	26.42	.66	16.76	1.44	36.58	.090	2.29	2500	500
WW-13B	1.094	27.79	1.215	30.86	1.031	26.19	1.132	28.75	.69	17.53	1.56	39.62	.090	2.29	2500	500
WW-14	1.110	28.19	1.233	31.32	1.043	26.49	1.157	29.39	.66	16.76	1.56	39.62	.090	2.29	2500	500
WW-14X	1.150	29.21	1.284	32.61	1.108	28.14	1.205	30.61	.66	16.76	1.56	39.62	.090	2.29	2500	500
WF 24-2	1.150	29.21	1.284	32.61	1.080	27.43	1.220	30.99	.75	19.05	1.56	39.62	-	-	1500	300
WF 25	1.180	29.97	1.314	33.38	1.115	28.32	1.260	32.00	.75	19.05	1.56	39.62	-	-	1500	300
WF 26	1.236	31.39	1.382	35.10	1.166	29.62	1.324	33.63	.75	19.05	1.69	42.93	-	-	1500	300
WW-15	1.237	31.42	1.382	35.10	1.167	29.64	1.288	32.72	.66	16.76	1.68	42.67	.090	2.29	2500	500
WW-16	1.312	33.32	1.465	37.21	1.249	31.72	1.364	34.65	.81	20.57	1.84	46.74	.120	3.05	1000	200
WF 27-2	1.312	33.32	1.466	37.24	1.249	31.72	1.427	36.25	.78	19.81	1.84	46.74	-	-	1000	200
WF 27	1.312	33.32	1.465	37.21	1.248	31.70	1.417	35.99	.93	23.62	1.84	46.74	-	-	1000	200
WW-16X	1.416	35.97	1.516	38.51	1.354	34.39	1.462	37.13	.69	17.53	1.75	44.45	.120	3.05	1000	200
WW-17	1.452	36.88	1.603	40.72	1.377	34.98	1.503	38.18	.63	16.00	1.94	49.28	.120	3.05	1000	200
WF-28	1.452	36.88	1.604	40.74	1.378	35.00	1.552	39.42	.75	19.05	1.94	49.28	-	-	1000	200
WW-18	1.580	40.13	1.714	43.54	1.515	38.48	1.649	41.88	.63	16.00	2.06	52.32	.120	3.05	1000	200
WW-19	1.730	43.94	1.887	47.93	1.650	41.91	1.780	45.21	.63	16.00	2.31	58.67	.120	3.05	1000	200
WF 30	1.730	43.94	1.888	47.96	1.650	41.91	1.828	46.43	.75	19.05	2.31	58.67	-	-	500	100
WF 31	1.810	45.97	1.975	50.17	1.731	43.97	1.916	48.67	.75	19.05	2.38	60.45	-	-	500	100
WW-210	1.850	46.99	2.020	51.31	1.788	45.42	1.917	48.69	1.00	25.40	2.44	61.98	.120	3.05	500	100
WF 32	1.850	46.99	2.020	51.31	1.788	45.42	1.973	50.11	1.12	28.45	2.44	61.98	-	-	500	100
1064	1.900	48.26	1.990	50.55	1.780	45.21	1.870	47.50	.57	14.48	2.34	59.44	-	-	2500	500
WW-21	1.927	48.95	2.058	52.27	1.857	47.17	1.988	50.50	.63	16.00	2.38	60.45	.120	3.05	1000	200
WF 34	2.067	52.50	2.243	56.97	2.005	50.93	2.197	55.80	1.12	28.45	2.69	68.33	-	-	250	50
WF 34-2	2.072	52.63	2.263	57.48	2.010	51.05	2.218	56.34	1.12	28.45	2.69	68.33	-	-	250	50
WW-221	2.079	52.81	2.228	56.59	2.015	51.18	2.132	54.15	.99	25.15	2.63	66.80	.120	3.05	500	100
WW-25A	2.125	53.98	2.406	61.11	2.063	52.40	2.344	59.54	1.00	25.40	2.69	68.33	.120	3.05	500	100
WF 35	2.136	54.25	2.312	58.72	2.074	52.68	2.265	57.53	1.12	28.45	2.75	69.85	-	-	250	50
WW-240	2.298	58.37	2.464	62.59	2.235	56.77	2.370	60.20	1.00	25.40	2.88	73.15	.120	3.05	500	100
WF 36	2.298	58.37	2.464	62.59	2.235	56.77	2.416	61.37	1.12	28.45	2.88	73.15	-	-	250	50
WW-33A	2.305	58.55	2.620	66.55	2.245	57.02	2.560	65.02	1.25	31.75	3.06	77.72	.120	3.05	250	50
WF-38	2.305	58.55	2.620	66.55	2.245	57.02	2.583	65.61	1.00	25.40	3.06	77.72	-	-	300	60
WW-250	2.395	60.83	2.602	66.09	2.333	59.26	2.500	63.50	1.13	28.70	3.00	76.20	.120	3.05	500	100
WF-37	2.395	60.83	2.602	66.09	2.333	59.26	2.556	64.92	1.25	31.75	3.00	76.20	-	-	250	50
WW-43A	2.475	62.87	2.725	69.22	2.405	61.09	2.650	67.31	.91	23.11	3.16	80.26	.120	3.05	250	50
WF 39	2.475	62.87	2.725	69.22	2.405	61.09	2.677	68.00	1.37	34.80	3.16	80.26	-	-	250	50
WW-44	2.638	67.01	2.759	70.08	2.568	65.23	2.661	67.59	.69	17.53	3.22	81.79	.120	3.05	500	100
WF-40	2.638	67.01	2.759	70.08	2.568	65.23	2.704	68.68	.81	20.57	3.21	81.53	-	-	250	50
WF 41	2.685	68.20	2.955	75.06	2.623	66.62	2.917	74.09	1.12	28.45	3.44	87.38	-	-	250	50
WW-55A	2.990	75.95	3.250	82.55	2.920	74.17	3.150	80.01	1.00	25.40	3.75	95.25	.120	3.05	250	50
WF-43	2.990	75.95	3.250	82.55	2.920	74.17	3.202	81.33	1.12	28.45	3.75	95.25	-	-	250	50
WW-53	2.995	76.07	3.150	80.01	2.925	74.30	3.080	78.23	.75	19.05	3.59	91.19	.120	3.05	250	50
WW-57A	3.090	78.49	3.370	85.60	3.020	76.71	3.322	84.38	1.00	25.40	3.81	96.77	.120	3.05	250	50

* For other material and color options, contact a Daemar Sales Representative.

WW Series Tapered Caps & Plugs with Wide, Thick Flanges (cont.)

Expanded!

Caplug No.	Dimensions														Packaging	
	A		B		C		D		E		F		G		Carton Quantity	Mini Pak Quantity
	In	mm	In	mm	In	mm	In	mm	In	mm	In	mm	In	mm		
WW-96A	3.225	81.92	3.562	90.47	3.155	80.14	3.517	89.33	1.12	28.45	4.00	101.60	.120	3.05	250	50
WF 45	3.324	84.43	3.458	87.83	3.244	82.40	3.398	86.31	.87	22.10	3.88	98.55	-	-	200	40
WF 45-2	3.347	85.01	3.486	88.54	3.265	82.93	3.418	86.82	.87	22.10	3.91	99.31	-	-	200	40
WW-502	3.790	96.27	3.920	99.57	3.710	94.23	3.840	97.54	.75	19.05	4.34	110.24	.120	3.05	250	50
WW-1064	4.011	101.88	4.135	105.03	3.937	100.00	4.061	103.15	.75	19.05	4.62	117.35	.120	3.05	100	20
WW-1076	4.640	117.86	4.815	122.30	4.570	116.08	4.685	119.00	.88	22.35	5.17	131.32	.120	3.05	100	20
WW-1107	6.611	167.92	6.683	169.75	6.530	165.86	6.630	168.40	1.43	36.32	7.12	180.85	.120	3.05	100	20